

LIST AND RETAIL PRICES OF PARTS OF GROVER & BAKER'S No. 9 SHUTTLE SEWING MACHINE.

	\$	Cts.		\$	Cts.
Bed Piece,	10	00	Shuttle Cam Stud,		15
Front Plate,		75	Shuttle Lever,		75
			Shuttle Lever Stud,		50
Back Plate,		63	Shuttle Driver,	1	00
			Shuttle Driver Spring,		06
Needle Plate,		31	Spring Washer,		02
			Shuttle Race,	1	00
Arm,	4	00	Shuttle Complete,	1	50
Face Plate,	2	00	Shuttle Cover Complete,	1	00
			Shuttle Cover only,		75
Presser Bar,		75	Bobbin Step,		10
			Step Spring,		02
Presser Spring,		12	Cover Hinge Pin,		02
			Shuttle Thread Spring,		06
Presser Lifter,		50	Shuttle Heel,		10
			Shuttle Point,		10
Presser Foot,		50	Bobbins, (per dozen,)		75
			Feeder Complete,	3	00
Presser Spring Regulator,		35	Feeder Bar,	1	00
			Feeder Top,		50
Needle Bar,		75	Feeder Bunter,		12
			Feeder Spring, (spiral,)		10
Clamp,	1	12	Feeder Wedge,		37
Clamp Nut,		12	Feeder Stop,		20
Needle Bar Disk Screw,		06	Feeder Stitch Screw,		25
Needle Bar Disks, each,		06	Feeder Stitch Nut,		38
Needle Bar Disk Spring,		02	Feeder Stitch Nut Spring,		12
Needle Bar Trundle,		15	Gauge,		25
Needle Bar Stud,		15			37
Nipper Disks, each,		10	Plated,		
Nipper Spring,		25	Pulley Wheel,	1	50
Eyelet,		02			00
Needle Lever,	3	00	Plated,	4	25
			Oil Fender,		75
			Spooler,		10
Needle Lever Stud,		50	Screw, Needle Plate, each,		06
			Screw, Face Plate, each,		06
			Screw, Nipper,		06
Tension Complete,	1	25	Screw, Arm, each,		06
			Screw, Presser Foot,		06
			Screw, Presser Spring Regulator,		06
Tension Spindle,	1	62	Screw, Presser Lifter,		06
Tension Spindle,		50	Screw, Shaft,		06
Tension Nut,		38			08
			Plated,		
Tension Spring,		13	Screw, Cam, each,		12
			Screw, Shuttle Driver,		06
			Screw, Shuttle Driver Spring,		06
Tension Disks, each,		12	Screw, Shuttle Race, each,		06
Spool Spindle,		12	Screw, Feeder Top,		06
			Screw, Feeder Bunter,		06
			Screw, Feeder Wedge,		06
Shaft,	2	00	Screw, Feeder Stop,		06
Shaft Washer,		12	Screw, Feeder Stitch Spring,		06
			Screw, Oil Fender, each,		06
			Screw, Gauge,		25
Needle Cam,	3	00			37
Needle Cam Trundle,		15	Plated,		
Needle Cam Stud,		15			
Trundle Stud Nut,		10			
Shuttle Cam,	3	00			
Shuttle Cam Trundle,		15			

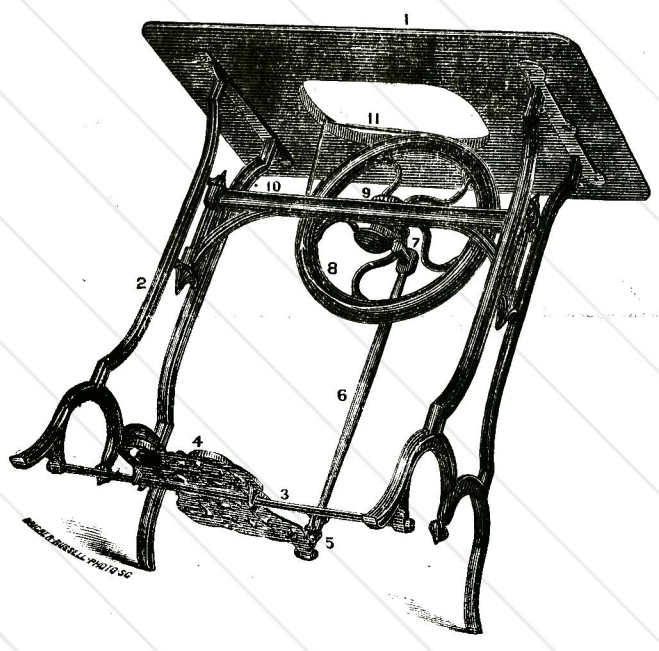
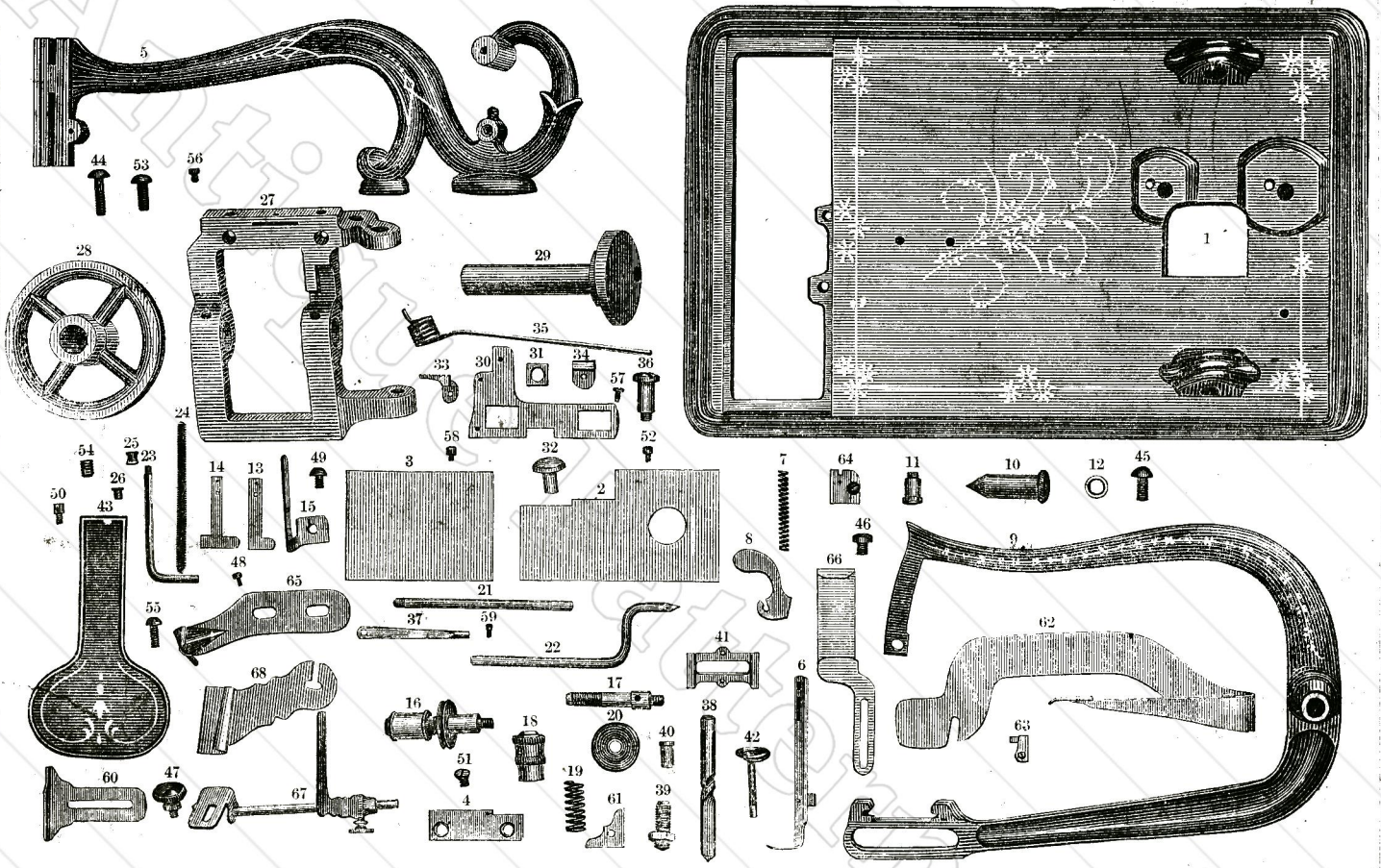

TABLE AND PARTS.

- No.
- 1. Table.
- 2. Leg.
- 3. Iron Rod and Nuts.
- 4. Treadle.
- 5. Toggle-joint.
- 6. Pitman.
- 7. Crank-pin.
- 8. Wheel.
- 9. Wheel-hanger.
- 10. Cross Bar.
- 11. Belt.

LIST AND RETAIL PRICES OF PARTS OF

Nos. 23, 24, 22, 25, 26, 27.

No.		\$	Cts.	No.		\$	Cts.
1	Bed Piece,.....	Nos. 23 and 24,	10	00	25	Thread Guide Cap,.....	10
		No. 22,	12	00		Plated,	12
		No. 25,	12	50	26	Thread Spring Cap,.....	12
		No. 26,	15	50	27	Pulley Hanger,.....	3
		No. 27,	17	00	28	Pulley,.....	1
2	Front Plate,.....				29	Pulley Shaft,.....	2
		Plated,	1	25	30	Feeder Plate,.....	50
3	Back Plate,.....				31	Feeder Washer, each.....	15
		Plated,	1	13	32	Feeder Pin, each,.....	20
4	Needle Plate,.....				33	Feeder Top,.....	50
		Plated,			34	Feeder Bunter,.....	25
5	Presser Arm,.....	Nos. 23 and 24,	4	00	35	Feeder Spring,.....	12
		No. 22,	6	00	36	Feeder Spring Stud,.....	31
		No. 25,	6	50	37	Stitch Regulator,.....	25
		No. 26,	6	50	38	Spiral,.....	1
		No. 27,	7	00	39	Spiral Step and Nut,.....	50
6	Presser,.....		1	00	40	Spiral Bolster,.....	37
		Plated,	1	25	41	Driver,.....	50
7	Presser Spring,.....				42	Circular Needle,.....	75
8	Presser Lifter,.....				43	Oil Fender,.....	20
		Plated,			44	Screw, Presser Arm, each.....	06
9	Needle Arm,.....	Nos. 23 and 24,	4	00	45	Screw, Center, each.....	06
		No. 22,	6	00	46	Screw, Needle,.....	12
		No. 25,	6	50	47	Screw, Gauge,.....	25
		No. 26,	8	00		Plated,	37
		No. 27,	8	50	48	Screw, Nipper,.....	06
10	Needle Arm Center, each,.....				49	Screw, Nipper Spring Guide,.....	06
		Plated,			50	Screw, Thread Guide,.....	06
11	Needle Arm Driving Pin,.....				51	Screw, Needle Plate, each.....	10
12	Driving Pin Trundle,.....				52	Screw, Circular Needle,.....	06
13	Nipper,.....				53	Screw, Pulley Hanger, each.....	06
14	Nipper Spring,.....				54	Screw, Pulley,.....	06
15	Nipper Spring Guide,.....				55	Screw, Oil Fender,.....	06
16	Tension Complete,.....		1	25	56	Screw, Feeder Pin, each.....	06
		Plated,	1	62	57	Screw, Feeder Bunter,.....	06
17	Tension Spindle,.....				58	Screw, Feeder Top,.....	06
18	Tension Nut,.....				59	Screw, Stitch Regulator,.....	06
		Plated,			60	Gauge,.....	25
19	Tension Spring,.....					Plated,	37
		Plated,			61	Needle Gauge,.....	
20	Tension Disks, each.....				62	Corder,.....	3
21	Spool Spindle, (upper).....				63	Corder Step,.....	00
		Plated,			64	Braider,.....	1
22	Spool Spindle, (under).....				65	Binder,.....	2
23	Thread Guide,.....					No. 3,	00
		Plated,			66	Tuck Guide,.....	1
24	Thread Spring,.....				67	Quilting Gauge,.....	50
		Plated,			68	Hemmers, per set,.....	5
							00